

September 2, 2020

ADDENDUM NO. 2
to

WALKER ROAD TANK FOUNDATION DESIGN RFQ/P

Project No.: 20-016

TO ALL HOLDERS OF RFQ/P:

Your attention is directed to the following interpretations of, changes in, and additions to the RFQ/P

A. In Section 1.4

1. Page 2, **DELETE:** "Final Statement of Qualifications and Proposal submissions must be received by 2:30 PM EST on September 2nd at the address shown in Section 3.1." And **SUBSTITUTE THEREFORE:** "Final Statement of Qualifications and Proposal submissions must be received by 2:30 PM EST on September 16th at the address shown in Section 3.1."

B. In Section 2.1.A

Page 3, **DELETE:** "The Consultant shall submit to the Authority the requirements for additional survey as necessary to prepare the required design drawings. The Authority will provide additional survey and mapping required."

C. In Section 2.1.C

Page 4, after "The report shall include the following geotechnical recommendations and parameters:" **DELETE:** "Tank backfill material type and placement procedures" and "As it is the Authority's intent that part of the tank wall will be backfilled with native material (backfill material shall NOT contain sulfides or expansive material), the following soil backfill information shall also be provided:

- Equivalent liquid at-rest pressure (pcf)
- Backfill pressure increase on wall under seismic conditions (pcf)
- Equivalent liquid active earth pressure (pcf)
- Equivalent liquid passive earth pressure (pcf)
- Backfill soil density (pcf)
- Downward drag coefficient on backfill of wall
- Vehicle load on backfill"

D. In Appendix A

DELETE: Drawing S-2 and **SUBSTITUTE THEREFOR:** Drawing S-2R, attached hereto.

Answers to the following questions that have been received will be incorporated into the RFQ/P with this Addendum.

Question: Will you accept PDF proposals by e-mail?

Answer: In accordance with the terms of the RFQ-P, proposals must be submitted by delivery service only.

Question: Can you provide the tank base slab elevation?

Answer: It is expected that the tank base slab elevation will be 1035.

Question: Section 3.1-C of the RFQ/P requires a simple and straightforward proposal without color displays, promotional materials, etc. Is there a maximum page limit? As part of demonstrating our capabilities, is MCWA interested in reviewing the proposer's project approach/methodology along with brief profiles/examples of a Consultant's past experience and representative projects (project sheets)?

Answer: There is no maximum page limit, although short concise write-ups are preferred. Brief descriptions of approach/methodology and related experience are encouraged.

Question: Please confirm this project involves both the geotechnical and structural design of the tank foundation and preparation of corresponding construction documents by the selected Consultant.

Answer: As indicated in Addendum No. 1, we are only requesting a geotechnical design report with the parameters listed in the RFQ/P. Structural design of the actual foundation is not required. In accordance with the RFQ/P, we will be looking for specifications for subgrade preparation and foundation base material/placement procedures.

Question: Relative to the survey provided with the RFQ/P, and the potential need to identify additional surveying and geotechnical investigation, has the tank location been established and can it be provided?

Answer: A revised drawing showing the proposed tank location is included as part of this Addendum.

Question: The RFQ/P states that the Consultant is to design the tank foundation and prepare the required design drawings (reference Section 2.1-A), but there are no drawing submission requirements listed. Please confirm and provide corresponding requirements for contract documents, any progress submissions, and/or design reviews.

Answer: No drawings are required other than what the Consultant elects to provide as part of the geotechnical report. Section 2.1.A has been modified as part of this Addendum.

Question: Will the documents prepared by the Consultant be bid separately from the tank, or will the documents be incorporated as part of the Authority's tank design and bid as one "combined" project?

Answer: The documents will be incorporated as part of the Authority's bidding documents for the tank construction.

Question: Has a project design and construction schedule been established? If so can it be shared?

Answer: At this time, we plan on bidding the project in the spring of 2021.

Question: What is the construction budget (overall as well as just the tank foundation)?

Answer: At this time we are estimating the total project cost at \$3 million.

Question: Are bidding phase services or some level of assistance to MCWA required during the bidding process on the part of the Consultant? If so, please provide.

Answer: Bidding phase services are not required on the part of the Consultant.

Question: Are other administration tasks required of the Consultant during the construction phase (i.e. reviewing RFIs, change orders and payment applications, preparing construction sketches, RFPs and construction change directives, final walkthrough and punch list, project close out, and preparation of record drawings), or will this be handled by MCWA?

Answer: These tasks will be handled by MCWA. Any construction related tasks required of the Consultant are included in Section 2.2.

MONROE COUNTY WATER AUTHORITY



Stephen M. Savage, P.E.

Director of Engineering

tjs

Red Circle: 110ft diameter tank
 Blue Circle: Work area needed for tank assembly

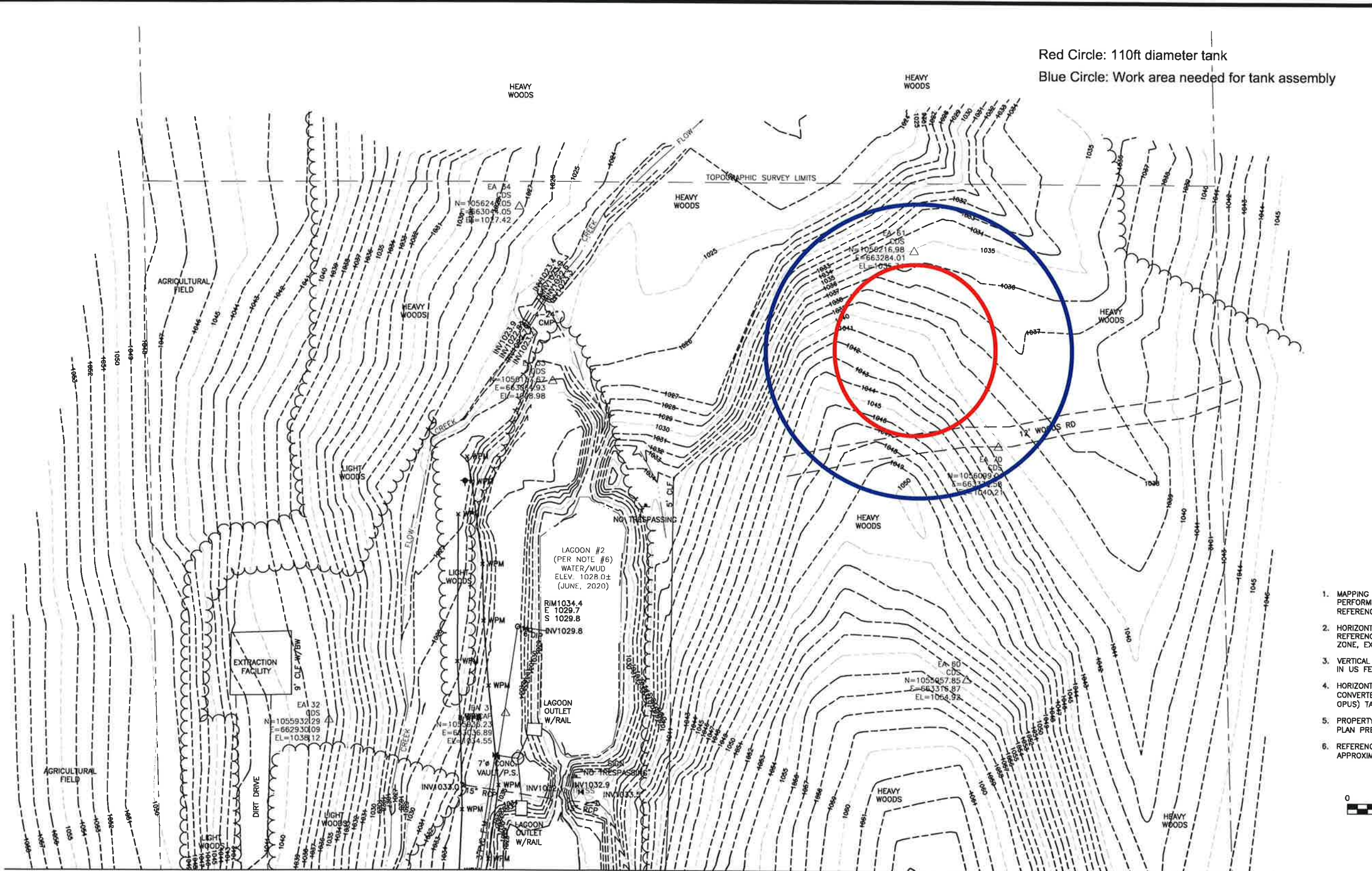

SURVEY NOTES:

1. MAPPING PREPARED BASED ON FIELD SURVEY PERFORMED BY ERDMAN ANTHONY IN JUNE, 2020. REFERENCE FB#2020-01, PAGE 70.
2. HORIZONTAL DATUM AND NORTH ORIENTATION REFERENCES NAD27, NEW YORK STATE PLANE, WEST ZONE, EXPRESSED IN US SURVEY FEET.
3. VERTICAL DATUM REFERENCES NGVD 29, EXPRESSED IN US FEET.
4. HORIZONTAL AND VERTICAL CONTROL BASED ON CONVERTED (NCAT) GPS OBSERVATIONS (4-HR. OPUS) TAKEN AT TIME OF FIELDWORK.
5. PROPERTY MARKERS RECOVERED ALSO SHOWN ON PLAN PREPARED BY STANTEC, LAST DATED 5/17/04.
6. REFERENCE TO McFARLAND JOHNSON SITE PLAN APPROXIMATE DATE OF APRIL, 1981 (ILLEGIBLE).



MATCH TO SHEET 1

ERDMAN ANTHONY
 145 Culver Road, Suite 200
 Rochester, NY 14620
 Telephone 585 427 8888
 Facsimile 585 427 8914
 www.erdmananthony.com

NO.	DESCRIPTION	BY	DATE
0.	RELEASED FOR REVIEW	DLS	?

NOTE: UNAUTHORIZED ALTERATION OR ADDITION TO THIS DRAWING IS A VIOLATION OF THE NEW YORK STATE EDUCATION LAW ARTICLE 145, SECTION 7209.

ALL RIGHTS RESERVED:
 No part of this document may be reproduced, stored in a retrieval system, or transmitted, in any form or by any means electronic, mechanical, photocopying, recording, or otherwise, without the written authorization of ERDMAN ANTHONY.

CLIENT:
MONROE COUNTY WATER AUTHORITY

PROJECT NAME:
MCWA 20-001 WALKER ROAD TANK SITE PAVILION, NY

DRAWING TITLE:
TOPOGRAPHIC SURVEY PLAN

SCALE: 1"=30'	DATE: 6/30/20
DES. BY: n/a	DR. BY: PDL/DLS
CK'D BY: DLS/TJF	EM PROJ. NO. 19576.07
SHEET NO. 2 OF 2	DRAWING NO. S-2R